



# 1500 Vinyl Collection

Sliding Windows

BUILDER



Building choice into every view.

# 1500 Sliding Windows



When you build a lot of homes, you expect a lot from your windows. Quality. Performance. Value. A company you can count on. Our new 1500 vinyl windows offer all that and more. Including a full range of options to meet your every need.

## Frame Options



Brickmould

Beveled

Flat

## Window Anatomy

Multi-chamber construction with fusion-welded sash and frame

7/8" or 1" dual or triple pane insulated glass with Warm Edge spacer saves energy

Integral J-channel for simple, secure siding installation (optional double utility trim)



## Upgrade your view

- High performance in a builder's window
- Traditional or contemporary frame design
- SDL or GBG grilles
- Sizes to meet your need
- Egress Size: 4040SL, 3050SH
- Limited Lifetime Warranty

## Color options \*Some restrictions may apply.



## Grille types Also available with no grilles.

### GBG Grilles



3/4" Flat, 5/8" or 1" Sculptured

### SDL Grilles



7/8" or 1-1/4" SDL with Shadow Bar

## Glass options Compare U-Factor ratings

### Low-E



7/8" Low-E	.35	SHGC .28
One lite of Low-E.		
7/8" Low-E <sup>SC</sup>	.35	SHGC .21
One lite of solar cooling Low-E.		
7/8" Low-E2+	.30	SHGC .27
One lite of Low-E and one lite of Interior Surface Low-E.		

### Low-E with Argon

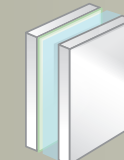

7/8" HP	.32	SHGC .28
One lite of Low-E with argon.		
7/8" HP <sup>SC</sup>	.32	SHGC .21
One lite of solar cooling Low-E with argon.		
7/8" HP2+	.28	SHGC .27
One lite of Low-E and one lite of Interior Surface Low-E with argon.		

### Triple-Glazed



7/8" HP2 <sub>Max</sub>	.26	SHGC .24
Two lites of Low-E with two chambers of argon.		
7/8" HP3 <sub>Max</sub>	.24	SHGC .21
Two lites of Low-E, two chambers of argon, one lite of Interior Surface Low-E.		
1" HP3 <sub>Max</sub>	.22	SHGC .21
Two lites of Low-E, two chambers of argon, one lite of Interior Surface Low-E.		

Values reflect 5030 call size brickmould units simulated with 3mm glass, no grilles, non-reinforced, WarmEdge spacer. Beveled frame thermal values may differ slightly.



# easyinstall

for a quick, correct fit

- Alignment clips
- Double utility trim
- Integral J-channel
- Jamb extensions or drywall receiver options
- Accessory grooves
- Protective construction film

## Window Highlights



Interior



### Removable Sash

Operating sash is removable for easy cleaning.



### Jamb Alignment Clips

Aligns and holds frame in place during installation; enables one person to center smaller windows.



### Interlocking Sash

Sash locks tightly together to help keep out intruders and inclement weather.



### Smooth Operation

Push/pull rails and wide brass rollers make opening and closing effortless.



### Forced Entry Resistant Locks

Enhanced security locks meet tough AAMA forced entry requirements. Auto-lock option available.



Auto Lock



Exterior



Optional H-LC 50 upgrade available in limited sizes





Building choice  
into every view

# WindowSpecs

## FRAME

3 1/2" dual wall brickmould frame depth  
 2 7/8" beveled frame depth  
 1 3/8" integral nail fin set back  
 Optional 1/2" flush flange for block installs  
 Optional 3 1/2" flat casing for rectangles and arches  
 Optional double utility trim simplifies siding installation  
 Custom and traditional sizing to meet your needs  
 Integral J-pocket simplifies siding installations  
 Interior/exterior accessory grooves  
 Screen clip Patent #: 61738783

## SASH

Interlocking sash with dual pile weatherstripping  
 Interior glazed fixed glass  
 Exterior glazed operating sash  
 Dual push rails for easy operation  
 Sash lifts out for easy cleaning  
 Brass rollers ensure smooth operation  
 Half screens (shipped separately)

## GLASS

Double: Low-E, Low-E<sup>SC</sup>, Low-E2+, Low-E2+<sup>SC</sup>, HP, HP<sup>SC</sup>, HP2+, HP2+<sup>SC</sup>, LE<sup>PS</sup> and HP<sup>PS</sup>  
 Triple: HP2<sub>MAX</sub>, HP2<sub>MAX</sub><sup>SC</sup>, HP3<sub>MAX</sub>, HP3<sub>MAX</sub><sup>SC</sup>  
 Optional Warm Edge+ spacers  
 Configurable STC values up to 34  
 Impact, tempered, obscure and rain options  
 Bronze tint, Grey tint and Black Spandrel options

## GRILLES

GBG (Grilles Between Glass) – 3/4" Flat, 5/8" or 1" Sculptured  
 SDL (Simulated Divided Lite) – 7/8" or 1 1/4" with Shadow Bar  
 Colonial, Plaza, Prairie, Diamond, Gothic patterns available

## LOCKS

Standard forced entry resistant cam lock  
 Self-latching forced entry resistant auto-lock option

## PERFORMANCE CERTIFICATIONS



FLORIDA APPROVED FL16102

For a list of Ply Gem's Florida approved products visit [floridabuilding.org](http://floridabuilding.org).



CANADIAN STANDARDS ASSOCIATION CERTIFIED



TEXAS DEPARTMENT OF INSURANCE  
 WIN1767 non-impact, WIN1771 impact

Product Type	Test Unit Size (inches)	Overall Rating	NAFS Product Performance							Housing Performance	
			Air Infiltration (scfm/ft²)	Air Exfiltration (scfm/ft²)	Water Pressure (psf)	Structural Pressure (psf)	Test Standard(s)	Florida Approval	TDI Approval	AAMA 1704 Wind Zone	AAMA 1704 Egress Rated
Horizontal Slider (XD)	63 x 48	HS-LC50	0.08	0.07	7.52	+60/-60	NAFS 05, 08, 11	FL16102	WIN-1767	WZ III	Yes
	71.5 x 35.5	HS-LC50	0.07	0.07	7.52	+50/-50	NAFS 05, 08, 11	FL16102			
	72 x 56	HS-LC30	0.07	0.07	7.52	+30/-35	NAFS 05, 08, 11	FL16102	WIN-1767		
	72 x 72	HS-LC25	0.08	0.07	7.52	+25/-25	NAFS 05, 08, 11	FL16102	WIN-1767	WZ I	Yes
	63 x 48	HS-LC50	0.08	0.07	7.52	+60/-60	AAMA 506-06, 08	FL16102		NA	NA
Horizontal Slider (XD-Even)	63 x 44	HS-LC45	0.09	0.06	6.89	+45/-45	NAFS 05, 08, 11	FL16102	WIN-1767	WZ III	No
	72 x 56	HS-LC40	0.09	0.06	6.89	+40/-45	NAFS 05, 08, 11	FL16102	WIN-1767	WZ III	Yes
	84 x 63	HS-LC30	0.09	0.06	6.89	+30/-30	NAFS 05, 08, 11	FL16102	WIN-1767	WZ I	Yes
	96 x 72	HS-R15	0.09	0.06	6.89	+15/-15	NAFS 05, 08, 11	FL16102	In Process	WZ I	Yes
	108 x 72	HS-R15	0.11	0.06	5.43	+15/-15	NAFS 05, 08, 11	FL16102	In Process	WZ I	Yes
Horizontal Slider (XD-QHD)	63 x 44	HS-LC50	0.10	0.07	7.52	+50/-50	NAFS 05, 08, 11	FL16102	WIN-1767	WZ III	No
	72 x 56	HS-LC45	0.10	0.07	7.52	+45/-45	NAFS 05, 08, 11	FL16102	WIN-1767	WZ III	No
	84 x 63	HS-LC30	0.10	0.07	7.52	+30/-35	NAFS 05, 08, 11	FL16102	WIN-1767	WZ I	No
	96 x 72	HS-LC25	0.10	0.07	7.52	+25/-25	NAFS 05, 08, 11	FL16102	WIN-1767	WZ I	Yes
	108 x 72	HS-R15	0.12	0.12	5.43	+15/-15	NAFS 05, 08, 11	FL16102	In Process	WZ I	Yes

Impact Rated

### Test Standards

AAMA/WDMA/CSA 101/LS.2/A440-05 (NAFS-05)  
 AAMA/WDMA/CSA 101/LS.2/A440-08 (NAFS-08)  
 AAMA/WDMA/CSA 101/LS.2/A440-11 (NAFS-11)

AAMA 506-06  
 AAMA 506-08

### Performance Class Designations

R - Residential  
 LC - Light Commercial

